

FRONT VIEW

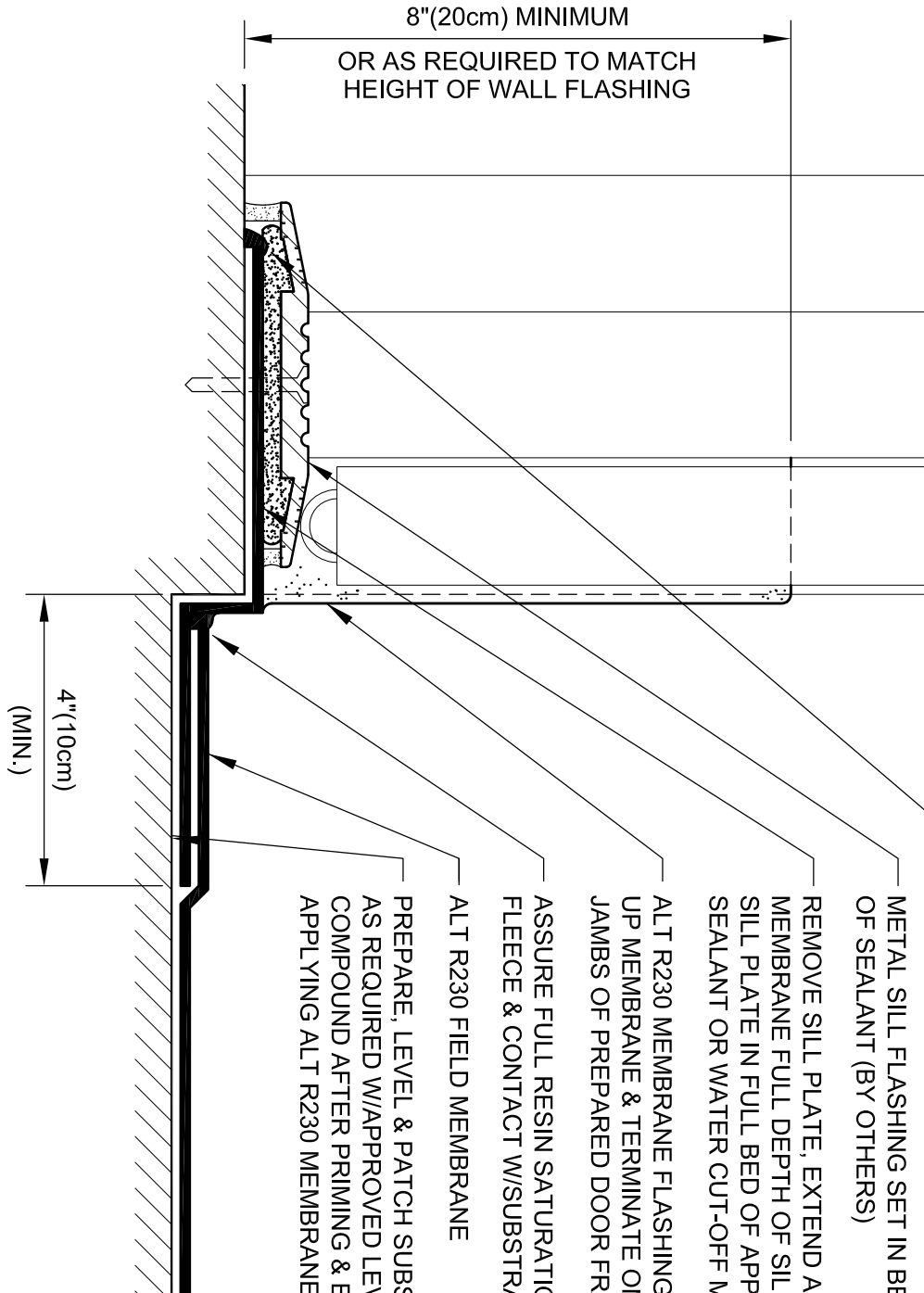

8"(20cm) MINIMUM  
OR AS REQUIRED TO MATCH  
HEIGHT OF WALL FLASHING

4"(10cm)  
(MIN.)

- ALT R230 RESIN BEAD TYPICAL @ ALL MEMBRANE TERMINATION POINTS.
- METAL SILL FLASHING SET IN BED OF SEALANT (BY OTHERS)
- REMOVE SILL PLATE, EXTEND ALT R230 MEMBRANE FULL DEPTH OF SILL & RESET SILL PLATE IN FULL BED OF APPROVED SEALANT OR WATER CUT-OFF MASTIC.
- ALT R230 MEMBRANE FLASHING-TURN UP MEMBRANE & TERMINATE ONTO JAMBS OF PREPARED DOOR FRAME.
- ASSURE FULL RESIN SATURATION OF FLEECE & CONTACT W/SUBSTRATE.
- ALT R230 FIELD MEMBRANE
- PREPARE, LEVEL & PATCH SUBSTRATE AS REQUIRED W/APPROVED LEVELING COMPOUND AFTER PRIMING & BEFORE APPLYING ALT R230 MEMBRANE (TYP.)



**TYPICAL LOW DOOR SILL FLASHING**

REVISION 0	ISSUE DATE 1-15-2010	SCALE N.T.S.	DRAWN BY D.R.W.
---------------	-------------------------	-----------------	--------------------

DRAWING NO.:  
**M-2B**  
AM\_02B