

FRONT VIEW

2"(5cm) MINIMUM
OR AS REQ'D. TO
MATCH HEIGHT OF
WALL FLASHING

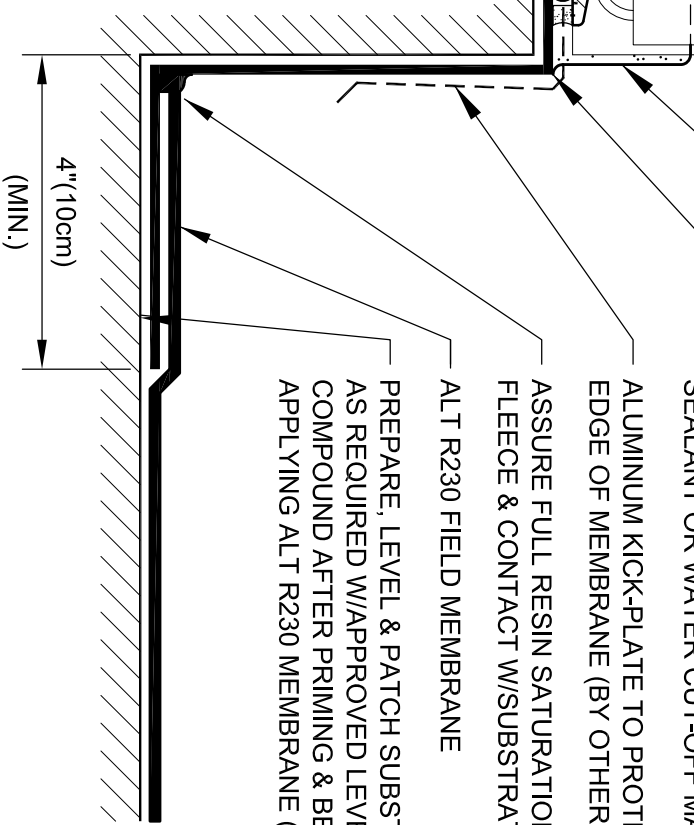

4" (10cm)
(MIN.)

- ALT R230 RESIN BEAD TYPICAL @ ALL MEMBRANE TERMINATION POINTS.
- APPLY APPROVED SEALANT BETWEEN DOOR FRAME AND PROTEC MEMBRANE AS REQUIRED (BY OTHERS)
- METAL SILL FLASHING SET IN BED OF SEALANT (BY OTHERS)
- REMOVE FRAME AS REQUIRED. TURN UP ALT R230 MEMBRANE & TERMINATE ONTO JAMBS OF PREPARED DOOR OPNG.
- REMOVE SILL PLATE, EXTEND ALT R230 MEMBRANE FULL DEPTH OF SILL & RESET SILL PLATE IN A FULL BED OF APPROVED SEALANT OR WATER CUT-OFF MASTIC.
- ALUMINUM KICK-PLATE TO PROTECT EDGE OF MEMBRANE (BY OTHERS)
- ASSURE FULL RESIN SATURATION OF FLEECE & CONTACT W/SUBSTRATE.
- ALT R230 FIELD MEMBRANE
- PREPARE, LEVEL & PATCH SUBSTRATE AS REQUIRED W/APPROVED LEVELING COMPOUND AFTER PRIMING & BEFORE APPLYING ALT R230 MEMBRANE (TYP.)



TYPICAL DOOR SILL FLASHING

DRAWING NO.:

M-2A

REVISION 0	ISSUE DATE 1-15-2010	SCALE N.T.S.	DRAWN BY D.R.W.
---------------	-------------------------	-----------------	--------------------