

NOTE:

APPLY TOPCOAT OF ALT R230 RESIN OVER MEMBRANE & BROADCAST TO REFUSAL WITH KILN-DRIED QUARTZ SILICA @ AREAS WHERE NEW MORTAR WILL CONTACT ALT R230 MEMBRANE.

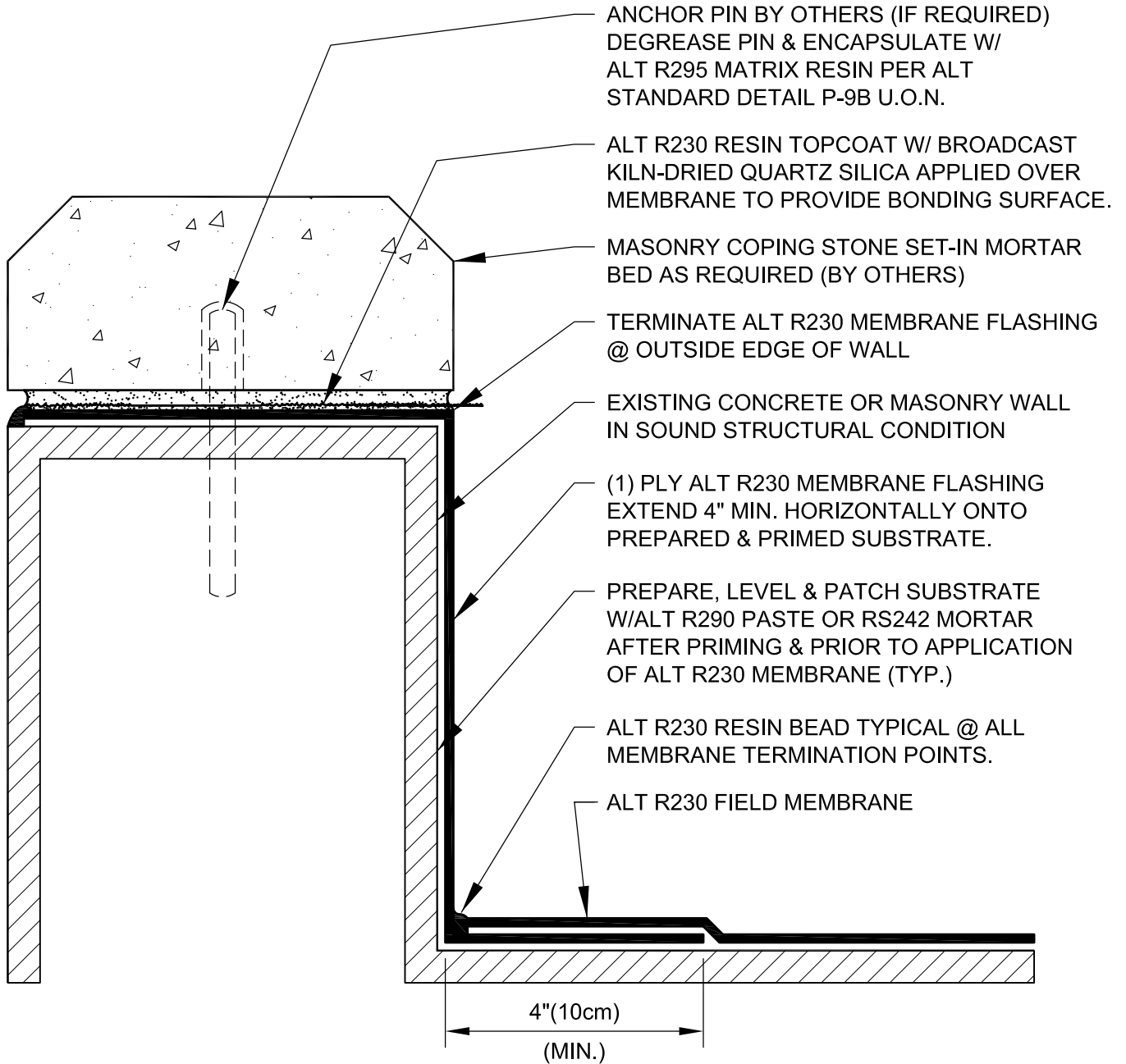

**TYPICAL PARAPET WALL FLASHING
W/ MORTAR-SET MASONRY COPING**

DRAWING NO.:

B-3C

REVISION

0

ISSUE DATE

1-15-2010

SCALE

N.T.S.

DRAWN BY

D.R.W.

AB_03C